

ABERNATHY and ASSOCIATES

Kenneth B. Abernathy Jr.

Wisconsin Registered Land Surveyor S-1594

Rt. 3, Box 273
Elkhorn, Wisconsin 53121
Phone: (414) 723-4260 (office)
(414) 723-4813 (residence)

PLAT OF SURVEY

Lot 16 of Hegeman's Subdivision, located in part of the Northeast 1/4 of the Southwest 1/4 and part of the Southeast 1/4 of the Southwest 1/4 of Section 10, Town 2 North, Range 18 East, Town of Lyons, County of Walworth, State of Wisconsin.

Lyondale Court

66' Wide

Lot 17

Lot 25

Lot 16
0.45 Acres ±

Lot 26

Lot 15

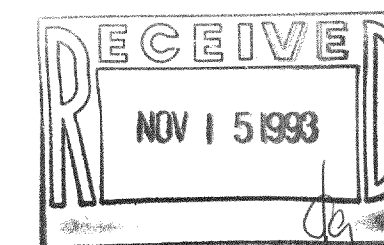

Legend

- FOUND IRON PIPE
- FOUND IRON ROD
- FOUND BRASS CAPPED MONUMENT
- FOUND CONCRETE MONUMENT
- CHISEL CUT IN CONCRETE
- SET IRON ROD, 24" LONG, WEIGHING 1.5 LBS., LINEAL FT., 3/4" DIA.
- SET IRON ROD, 30" LONG, WEIGHING 4.5 LBS., LINEAL FT., 1-11/16" DIA.
- RECORDED AS DIMENSION
- EXISTING FENCE

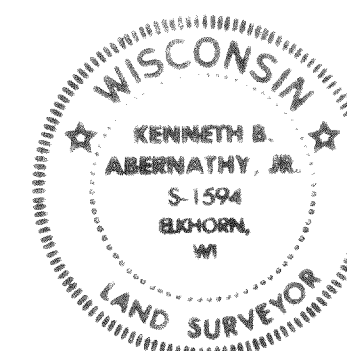

SCALE: 1" = 20 FEET

"I hereby certify that I have surveyed the above described property and that the above map is a true representation thereof and shows the size and location of the property, its exterior boundaries, the location of all visible structures and dimensions of all principal buildings thereon, boundary fences, apparent easements, roadways and visible encroachments, if any."

"This survey is made for the use of the present owners of the property, and also those who purchase, mortgage, or guarantee the title thereto within one year from date hereof."

Kenneth B. Abernathy Jr.

KENNETH B. ABERNATHY, JR.
WISCONSIN REGISTERED LAND SURVEYOR,
S-1594

Date: September 23, 1993 Job No. 1993.916

Ordered by: Paul Beeftink
30220 Lake Hills Drive
Burlington, Wisconsin
53105